



PARGE GUARD

THE MOISTURE MITIGATOR

by EarthWorks

ONE-STEP EASY INSTALL LATH DRAINAGE SYSTEM

*for the installation of Stucco, Natural and
Manufactured Thin Stone & Thin Brick*

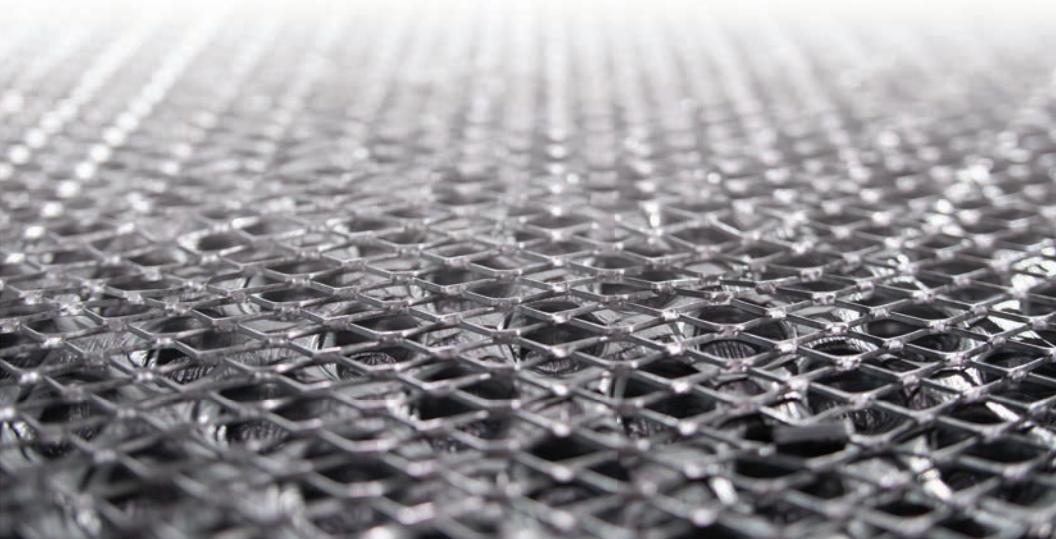



Parge Guard has revolutionized the lath and drainage industry by developing and perfecting an innovative system for adhered masonry. This cutting-edge solution tackles various challenges related to code compliance, warranty issues, and moisture control on building exteriors, including addressing problems caused by sun-driven moisture.

The Parge Guard system features a 2.5-gauge galvanized lath and incorporates a built-in drainage plane. Designed in an interlocking, overlay pattern, this system takes the guess work out of installation. Our one-step system creates a code compliant overlay, seamless drainage plane, and ensures your lath is installed correctly, every time.

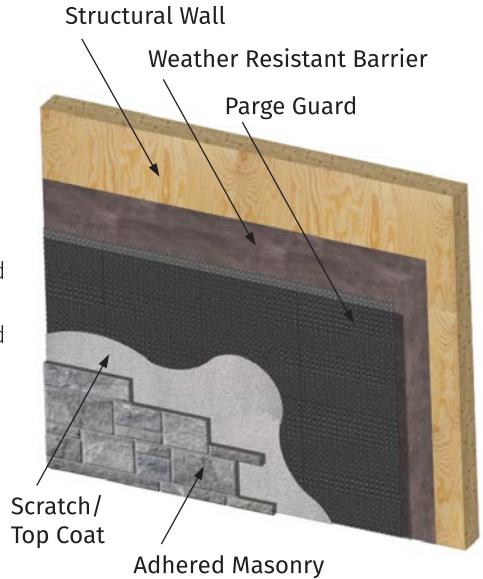

BENEFITS OF PARGE GUARD

- One step installation process of lath and drainage all in one is a labor saver.
- Factory assembled, patented design. Lath is right side up not inside out or upside down, and provides 1 inch required overlap by the IBC on all four sides
- Overlap of the drainage board prevents mortar bridging while providing continuous open cavities for liquid out the bottom and vapor to the top
- Parge Guard is self-furring and provides a clear drainage path as well as a predictable encapsulation plane for the lath in mortar
- Engineered to meet or exceed international & ASTM building code
- Exceeds drainage efficiency testing standards per ASTM E2273.
- Patented moisture mitigator click system minimizes wall penetration.

EASY INSTALLATION

Parge Guard makes installation of your lath drainage system a breeze. Start by making sure the structure is properly moisture managed and structurally sound.

Attach a starter strip along the base of the structure and over all penetrating areas including windows and doors. Once installed, add two layers of WRB (weather resistant barrier) over the top of the starter strips.



INSTALL STARTER STRIP



INSTALL WRB

Begin installing the Parge Guard panels by wrapping the first piece around the corner and attaching it to the 1st or 2nd stud. Install the additional panels in a running bond, working right to left, with the lath extending into the bottom of the starter strip. Secure each panel with nails or screws. The lath is pre-engineered to overlap the adjacent panels following the ASTM 1063 fastening requirements.



INSTALL THE FIRST PANEL



REPEAT TO TOP STAGGERING SEAMS

Repeat the process to the left and to the top of the panels, making sure to stagger the vertical seams of the panel below, and cutting as required to completely cover the area of the structure.

Contact a licensed contractor and always consult your local and state building codes for ASTM 1063 instructions and rules before installing Parge Guard.

Scan here
for complete
installation
instructions



PACKAGING

- Standard lath size
- Sheets are approx. 18 sq ft
- 5 assemblies per bundle
- 50 sheets per pallet:
approx. 900 sq ft/pallet
- Weight per pallet: approx. 400 lbs

PHYSICAL PROPERTIES

Lath and Accessories

Diamond and expanded metal lath and accessories are a carbon steel hot dipped galvanized G60 finish meeting ASTM C847 expanded metal lath, ASTM A653 sheet steel hot dip zinc coated process, and ASTM C1063 standard specification for installation of lathing and furring to receive cement based plaster.

WRB

Apparent thermal conductivity ASTM C518 - 15 0.0587 (W/m*K) R-value (m2*K/W) 0.1958

Polypropylene cup sheet

Puncture strength: ASTM D4833 65psi. Compressive strength: ASTM D1621 Mod up to 15,000 lbs/ft2 (72x103kg/M2). Flow capacity: ASTM D4716 16gpm/ft of width (200L/min/m of width)

Manufacturing

Information, images and specifications are based on the latest product information available. Product is 100% manufactured in the United States. Plastic is 100% recycled material. We reserve the right to make changes without notice due to constant improvements and engineering progress.

**Always follow your local and state building codes for ASTM 1063 instructions and rules.
Compliance with 2018 IBC and IRC.**



Scan here
for installation
instructions!



EarthWorksStone.com/Parge-Guard



EarthWorks

Contact us!

Phone: 573.547.9097 / Toll Free: 800.887.4555

Parge Guard is a Registered Patent and Trademark.